

Clad Aspen Casement



Known for its architecturally sculpted lines and hidden locking system, the Clad Aspen Casement has been re-engineered for even better structural performance and resistance to air and water intrusion.

JAN 21 2020

Standard Construction:

- 0.062" thick extruded aluminum exterior
- Clad frame is extruded with integral nail fin and corners are sealed with silicone and mechanically fastened.
- 5-11/16" overall frame depth with standard 4-9/16" jamb depth.
- 1-13/16" sash thickness. 2-3/16" sash stile and head rail, 2-11/16" bottom rail.
- 0.062" factory applied drip cap.
- Continuous foam frame weatherstrip. Leaf sash weatherstrip.
- Exclusive hidden locking system. Truth Encore operator and folding handle.
- Sash opens 90 degrees for easy cleaning and removal from the inside.
- Standard liftrail screen frame. Optional Flexscreen.

MINIMUM / MAXIMUM FRAME SIZES

Additional sizes may be available upon approval.

ASPEN CASEMENT – OPERATING (25 SQ/FT MAXIMUM)		ASPEN CASEMENT – STATIONARY/PICTURE	
Minimum Frame Width	16.5"	Minimum Frame Width	12"
Minimum Frame Height	18"	Minimum Frame Height	12"
Maximum Frame Width	42"	Maximum Frame Width	120"
Maximum Frame Height	96"	Maximum Frame Height	120"
		Maximum Square Feet	56



Performance Data:



Operating Casement: 36" x 84"

AIR INFILTRATION.....0.02/0.03/A3
WATER.....NO LEAKAGE @ 8.35 PSF
STRUCTURAL.....CW-PG55 (+55/-55)



Operating Casement: 42" x 76"

AIR INFILTRATION.....0.02/0.01/A3
WATER.....NO LEAKAGE @ 7.52 PSF
STRUCTURAL.....CW-PG50 (+50/-50)*



Operating Casement: 38" x 96" (single and multi-wide)

AIR INFILTRATION.....0.01/0.01/A3
WATER.....NO LEAKAGE @ 9.82 PSF
STRUCTURAL.....CW-PG65 (+65/-65)**



Casement Picture: 84" x 96"

AIR INFILTRATION.....0.01/0.01/FIXED
WATER.....NO LEAKAGE @ 7.52PSF
STRUCTURAL.....CW-PG50 (+50/-50)

*Unit requires high performance hinge and high performance dual arm operator.

**Unit requires high performance hinge and high performance dual arm operator. Multi-wide units require a 3/4" steel plate mull and installation straps to meet rating.

For a comprehensive list of tested and rated sizes and configurations, please refer to the Clad Aspen Casement Product Performance Guide (Structural) located in the Technical Resources Library on our website.

Thermal Performance (NFRC):

Air Filled			Argon Filled		
Low-E Clear	Low-E 366	Triple IG LE/CL/CL	Low-E Clear	Low-E 366	Triple IG LE/CL/CL
U-FACTOR.....0.29	U-FACTOR.....0.28	U-FACTOR.....0.23	U-FACTOR.....0.26	U-FACTOR.....0.25	U-FACTOR.....0.21
SHGC.....0.28	SHGC.....0.19	SHGC.....0.26	SHGC.....0.28	SHGC.....0.19	SHGC.....0.26
VT.....0.48	VT.....0.43	VT.....0.43	VT.....0.48	VT.....0.43	VT.....0.43
CR......57	CR......58	CR......65	CR......61	CR......61	CR......68

All values represent insulated glass units using standard black warm edge spacer. Additional glazing options available.

For a comprehensive list of glazing configurations, please refer to the Clad Aspen Casement Product Performance Guide (NFRC) located in the Technical Resources Library on our website.

Operable 4 9/16" JAMB

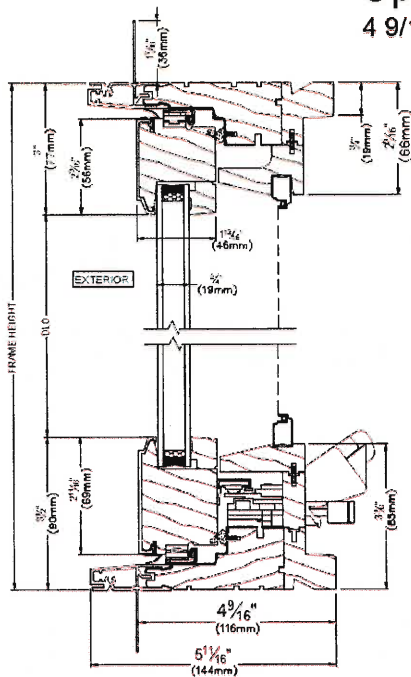

HEAD & SILL DETAIL
CLAD ASPEN CASEMENT

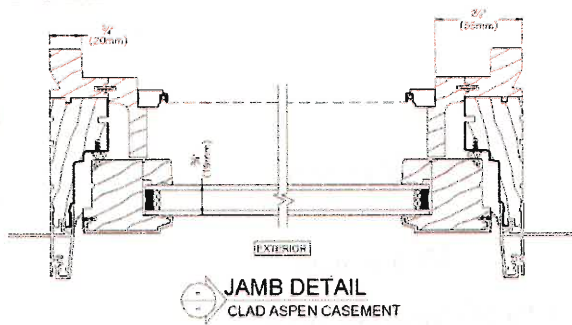

JAMB DETAIL
CLAD ASPEN CASEMENT

Operable 6 9/16" JAMB

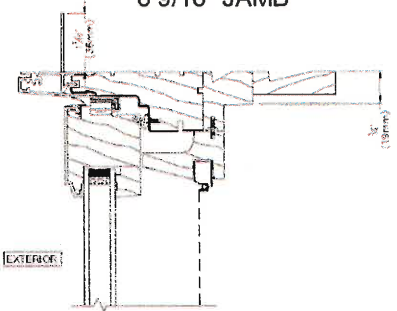

HEAD DETAIL
CLAD ASPEN CASEMENT

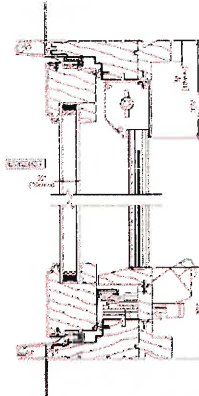

HEAD & SILL DETAIL
CLAD ASPEN CASEMENT
w/ GENIUS SCREEN

Additional product details may be found on our website www.sierrapacificwindows.com/ProfessionalResources/TechnicalLibrary

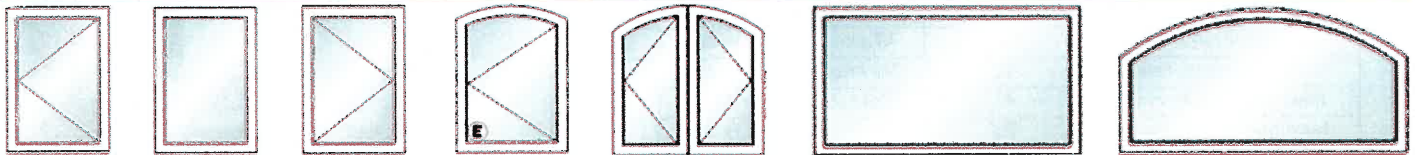

Typical configurations shown. Handling as viewed from the exterior. Contact us for additional options.

EXTERIOR TRIM OPTIONS

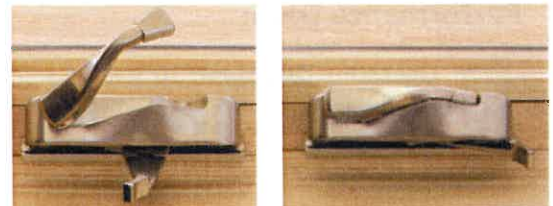
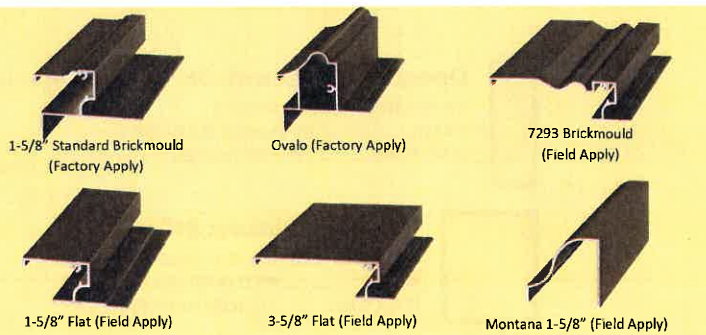

Exclusive hidden locking system with folding operating handles, available in 11 finishes: White, Bronze, Chestnut Bronze, Champagne, Matte Black, Oil Rubbed Forever Bronze*, Bright Brass*, Antique Brass*, Satin Nickel, Brushed Chrome, Polished Chrome*.

*Special Order. Extended lead-time.

Aspen Casement Additional Features

- Color Palette of 74 finishes in seven design collections, including 70 powder coated colors in AAMA 2605 and 4 anodized finishes. Some design collections only available in AAMA 2604.
- Extensive offering of performance glass available in black warm edge or Cardinal spacer for optimum efficiency.
- Simulated Divided Lites available in 5/8", 7/8" and 1" Putty; 5/8", 7/8", 1", 1-1/4" and 2" Traditional and Contemporary.
- Grilles-Between-Glass available in 5/8" and 1" flat.
- Optional veneer wrapped or Genius retractable screens.
- Factory mulling up to 5-wide, stacking and pocket mulls. Structural support options available.

Please visit our website www.sierrapacificwindows.com for additional details or to contact your nearest Sierra Pacific Branch or Dealer location.

Place Business Card or
Company Information Here

Clad Aspen Awning



Known for its architecturally sculpted lines and hidden locking system, the Clad Aspen Awning has been re-engineered for even better structural performance and resistance to air and water intrusion.

Standard Construction:

- 0.062" thick extruded aluminum exterior.
- Clad frame is extruded with integral nail fin and corners are sealed with silicone and mechanically fastened.
- 5-11/16" overall frame depth with standard 4-9/16" jamb depth.
- 1-13/16" sash thickness. 2-3/16" sash stile and head rail, 2-11/16" bottom rail.
- 0.062" factory applied drip cap.
- Continuous foam frame weatherstrip. Leaf sash weatherstrip.
- Exclusive hidden locking system. Truth Encore operator and folding handle.
- Standard liftrail screen frame. Optional Flexscreen.



MINIMUM / MAXIMUM FRAME SIZES

Additional sizes may be available upon request and approval.

ASPEN AWNING – OPERATING		ASPEN AWNING – STATIONARY/PICTURE	
Minimum Frame Width	16"	Minimum Frame Width	16"
Minimum Frame Height	16"	Minimum Frame Height	16"
Maximum Frame Width	60"	Maximum Frame Width	120"
Maximum Frame Height	60"	Maximum Frame Height	120"
		Maximum Square Feet	56

Performance Data:



Operating Awning: 60" x 36"

AIR INFILTRATION.....0.02/0.01/A3
WATER.....NO LEAKAGE @ 9.82 PSF
STRUCTURAL.....CW-PG65 (+65/-65)



Operating Awning/Picture: 42" x 24"-2/84" x 72"

AIR INFILTRATION.....0.01/0.01
WATER.....NO LEAKAGE @ 7.52PSF
STRUCTURAL.....CW-PG50 (+50/-50)*



Operating Awning: 60"x 60" (Multi-wide)

AIR INFILTRATION.....0.01/0.01/A3
WATER.....NO LEAKAGE @ 7.52 PSF
STRUCTURAL.....CW-PG50 (+50/-50)

For a comprehensive list of tested and rated sizes and configurations, please refer to the Clad Aspen Awning Product Performance Guide (Structural) located in the Technical Resources Library on our website.

*Unit will meet rating with 3/4" steel horizontal plate mull and installation straps.

Thermal Performance (NFRC):

Air Filled			Argon Filled		
Low-E Clear	Low-E 366	Triple IG LE/CL/CL	Low-E Clear	Low-E 366	Triple IG LE/CL/CL
U-FACTOR.....0.29	U-FACTOR.....0.28	U-FACTOR.....0.23	U-FACTOR.....0.26	U-FACTOR.....0.25	U-FACTOR.....0.21
SHGC.....0.28	SHGC.....0.19	SHGC.....0.25	SHGC.....0.27	SHGC.....0.18	SHGC.....0.25
VT.....0.47	VT.....0.42	VT.....0.43	VT.....0.47	VT.....0.42	VT.....0.43
CR......55	CR......56	CR......66	CR......59	CR......60	CR......69

All values represent insulated glass units using standard black warm edge spacer. Additional glazing options available.

For a comprehensive list of glazing configurations, please refer to the Clad Aspen Awning Product Performance Guide (NFRC) located in the Technical Resources Library on our website.

Operable

4 9/16" JAMB

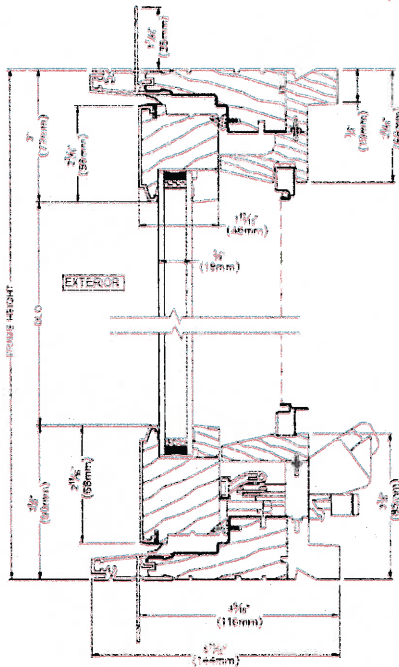

HEAD & SILL DETAIL
CLAD ASPEN AWNING

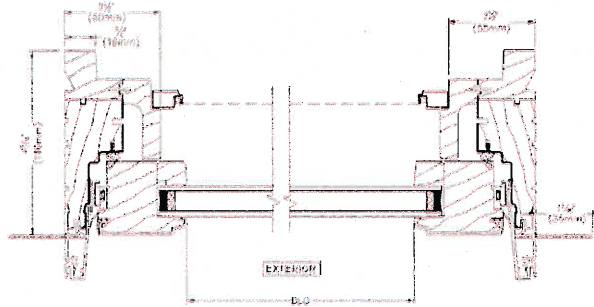

JAMB DETAIL
CLAD ASPEN AWNING

Operable

6 9/16" JAMB

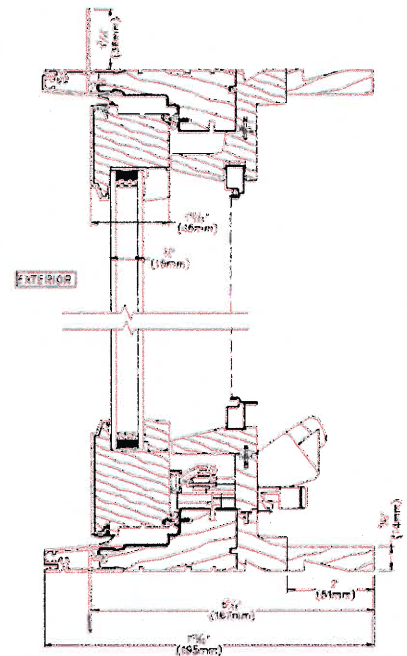

HEAD & SILL DETAIL
CLAD ASPEN AWNING

Additional product details may be found on our website www.sierrapacificwindows.com/ProfessionalResources/TechnicalLibrary

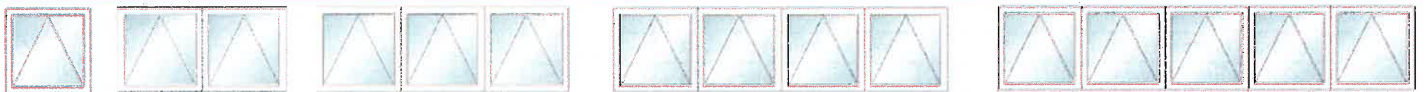

Typical configurations shown. Handing as viewed from the exterior. Contact us for additional options.

EXTERIOR TRIM OPTIONS

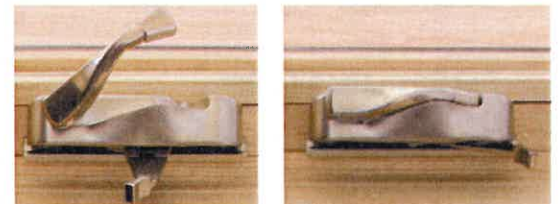
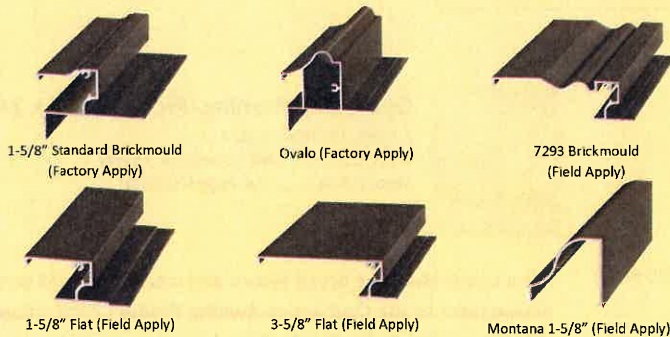

Exclusive hidden locking system with folding operating handles, available in 11 finishes: White, Bronze, Chestnut Bronze, Champagne, Matte Black, Oil Rubbed Forever Bronze*, Bright Brass*, Antique Brass*, Satin Nickel, Brushed Chrome, Polished Chrome*.

*Special Order. Extended lead-time.

Aspen Awning Additional Features

- Color Palette of 74 finishes in seven design collections, including 70 powder coated colors in AAMA 2605 and 4 anodized finishes. Some design collections only available in AAMA 2604.
- Extensive offering of performance glass available in black warm edge or Cardinal spacer for optimum efficiency.
- Simulated Divided Lites available in 5/8", 7/8" and 1" Putty; 5/8", 7/8", 1", 1-1/4" and 2" Traditional and Contemporary.
- Grilles-Between-Glass available in 5/8" and 1" flat.
- Optional veneer wrapped or Genius retractable screen.
- Factory mulling up to 5-wide, stacking and pocket mulls. Structural support options available.

Please visit our website www.sierrapacificwindows.com for additional details or to contact your nearest Sierra Pacific Branch or Dealer location.

Place Business Card or
Company Information Here