

DE CAUSSIN RESIDENCE

Carmelo St. 2NE of 8th Ave.

Carmel-by-the-Sea, CA

APN: 010-265-010

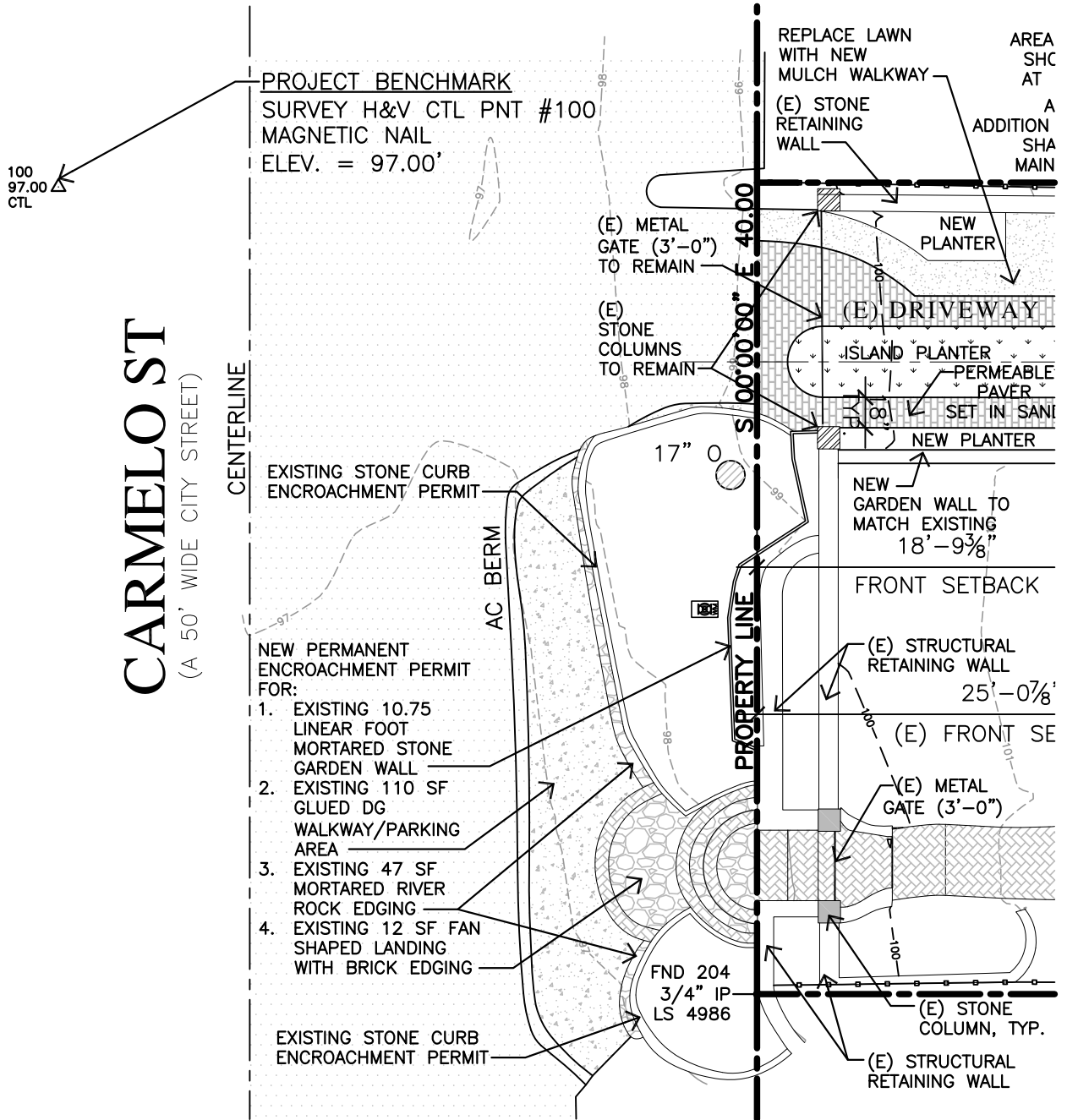

PARTIAL SITE PLAN

SCALE 1/8" = 1'-0"



Previous (Undated) photograph of right-of-way.

1. Existing mortared stone garden wall (not shown, hidden by the plants).
2. Existing glued DG walkway/parking area (previously dirt).
3. Existing mortared river rock edging (previously steppingstones).
4. Existing fan shaped landing with brick edging (previously steppingstones and brick edging).



Existing right-of-way encroachments.